

► PTW | PERFORMANCE

PTW | Performance Table

MODEL	Avg. Velocity at Nozzle on highest speed (FPM)	Air Flow Rate at Nozzle on highest speed (CFM)	Motor Power (Watts)	Amp Draw	Weight (lbs)	Sound Level (Measured 10' away from unit in a free field on highest speed)
PTW-24	1653	363	107	1.7	13	50 dba

► PTW | MECHANICAL DRAWINGS & INSTALLATION

TOP



FRONT

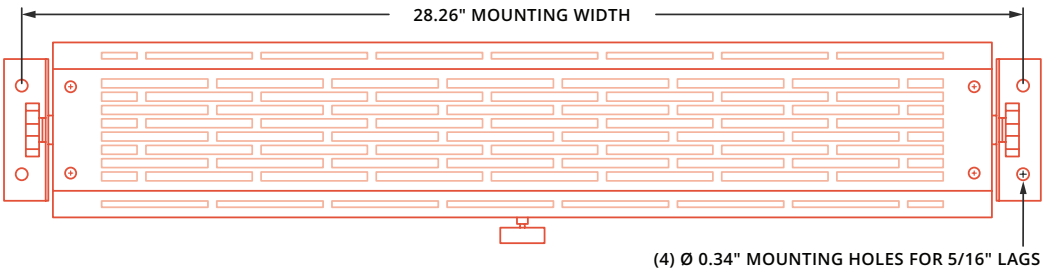

(4) Ø 0.34" MOUNTING HOLES FOR 5/16" LAGS

BOTTOM

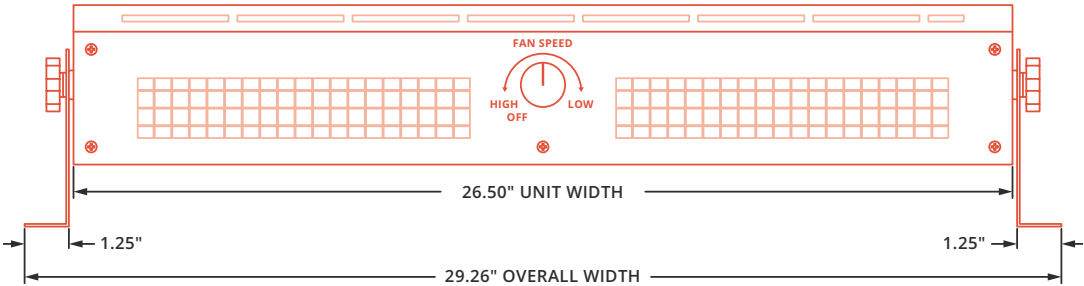

SIDE

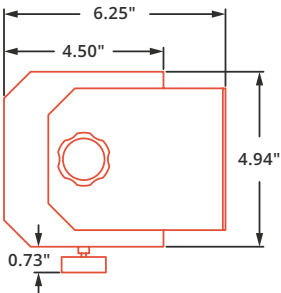

INSTALLATION

(4) Ø 0.34" Mounting Holes for 5/16" Lags